

SAR stazioni automatiche per l'accumulo ed il sollevamento di acque reflue

Le stazioni sono ideali per il sollevamento di acque reflue nelle installazioni ad un livello inferiore rispetto al sistema fognario. Le capacità disponibili dei serbatoi sono di 40, 100, 250 e 550 litri, tutti dotati di coperchio a tenuta per eventuali fughe di liquido o gas. La temperatura del liquido può raggiungere i +40°C, limite imposto dalle elettropompe sommergibili contenute all'interno dei serbatoi. Non è possibile l'utilizzo in ambienti con pericolo di esplosione e per il pompaggio di liquidi infiammabili.

SAR 40

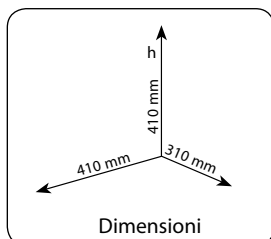

COMPONENTI

- Serbatoio in polietilene da 40 litri con coperchio
- Elettropompa monofase completa di interruttore a galleggiante e cavo di alimentazione di lunghezza 5 metri con spina Schuko
- Valvola di non ritorno
- Collegamenti per tubazioni di ingresso 1½" G, di uscita (vedi tabella) e di sfiato gas ½"G

TIPO Monofase	POTENZA		Q m³/h l/min	H (metri)													BOCCA DN
	kW	HP		0	1.2	2.4	3.6	4.8	6.0	7.2	8.4	9.6	10.8	12	13.2		
TOP 1	0.25	0.33	0	20	40	60	80	100	120	140	160	180	200	220	1"		
TOP 2	0.37	0.50	7	6	5.5	4.5	4	3	2.5	1.5	1				1¼"		
RXm 1	0.25	0.33	9	8	7.5	6.5	6	5.5	4.5	4	3	2.5	1.8	1			
RXm 2	0.37	0.50	7.5	6.5	5.8	5	4.3	3.5	2.8	2	1						
TOP-VORTEX	0.37	0.50	10	9.5	8.8	8	7.3	6.5	5.8	5	4.3	3.5	2.8	2			
			7	6.5	6	5.4	4.8	4.2	3.5	3	2.5	1.5					

SAR 100

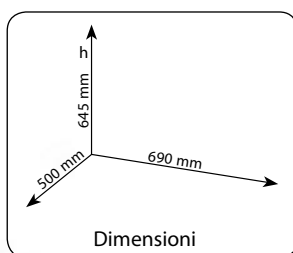

COMPONENTI

- Serbatoio in polietilene da 100 litri con coperchio
- Elettropompa monofase completa di interruttore a galleggiante e cavo di alimentazione di lunghezza 5 metri con spina Schuko
- Collegamenti per tubazioni di ingresso Ø 110 mm, di uscita (vedi tabella) e di sfiato gas Ø 50 mm

A RICHIESTA

- Kit di allarme composto da un galleggiante, una sirena autoalimentata e un quadro elettrico

TIPO Monofase	POTENZA		Q m³/h l/min	H (metri)																								BOCCA DN
	kW	HP		0	0.6	1.2	1.8	2.4	3.0	3.6	4.2	4.5	4.8	5.4	6.0	7.2	8.4	9.0	9.6	10.8	12.0	13.2	15.0	18.0	21.0	24.0		
TOP 2	0.37	0.50	0	10	20	30	40	50	60	70	75	80	90	100	120	140	150	160	180	200	220	250	300	350	400	1"		
TOP - VORTEX	0.37	0.50	9	8.5	8	7.7	7.5	7	6.5	6.3	6.1	6	5.7	5.5	4.5	4	3.5	3	2.5	1.8	1					1¼"		
TOP - MULTI 2	0.55	0.75	7	6.7	6.5	6.2	6	5.7	5.4	5.2	5	4.8	4.5	4.2	3.5	3	2.6	2.5	1.5									
RXm 2/20	0.37	0.50	30	29	28	27	26	24	22	19	17	15	10.5	5														
ZXm 1B/40	0.50	0.70	7	6.7	6.5	6.2	6	5.7	5.4	5.2	5	4.8	4.5	4.3	3.7	3.1	2.8	2.5	2								1½"	
ZXm 1A/40	0.60	0.85	9	8.7	8.6	8.5	8.4	8.3	8.1	8	7.9	7.8	7.6	7.5	7.1	6.6	6.5	6.1	5.7	5.2	4.7	4	2.5	1				
			11	10.7	10.5	10.4	10.3	10	9.7	9.6	9.5	9.3	9.2	9.1	8.8	8.6	8.2	7.8	7.4	7	6.5	5.7	4.3	2.8	1.5			

SAR 250

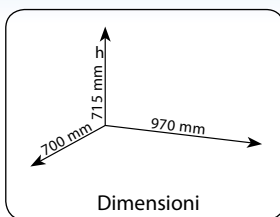

COMPONENTI

- Serbatoio in polietilene da 250 litri con coperchio
- Elettropompa monofase completa di interruttore a galleggiante e cavo di alimentazione di lunghezza 5 metri con spina Schuko
- Collegamenti per tubazioni di ingresso Ø 110 mm, di uscita (vedi tabella) e di sfogo gas Ø 50 mm
- Tubi di guida per la discesa della pompa (solo per VX-I)

A RICHIESTA

- **Kit di allarme** composto da un galleggiante, una sirena autoalimentata e un quadro elettrico
- **Prolunga da 300 mm** per l'apertura del serbatoio

TIPO Monofase	POTENZA		Q m³/h l/min	H (metri)																BOCCA DN	
	kW	HP		0	1.2	2.4	3.0	3.6	4.5	4.8	6.0	7.2	8.4	9.0	9.6	10.8	12	15	18		21
TOP - VORTEX	0.37	0.50	0	1.2	2.4	3.0	3.6	4.5	4.8	6.0	7.2	8.4	9.0	9.6	10.8	12	15	18	21	24.0	BOCCA DN
ZXm 1B/40	0.50	0.70	7	6.5	6	5.7	5.4	5	4.8	4.2	3.5	3	2.6	2.5	1.5						1 1/2"
ZXm 1A/40	0.60	0.85	9	8.5	8.4	8.3	8.1	8	7.8	7.5	7.1	6.6	6.5	6.1	5.7	5.2	4	2.5	1		1 1/2"
VXm 8/35-I	0.60	0.85	11	10.5	10.3	10	9.9	9.5	7.8	9.2	8.8	8.4	8.2	7.9	7.4	7	5.7	4.3	2.8	1.5	
VXm 10/35-I	0.75	1	8.4	8.2	7.8	7.5	7.2	7	6.7	6.5	6.1	5.7	5.2	4.7	4.2	3.7	2				2"
VXm 8/50-I	0.60	0.85	10	9.9	9.7	9.5	9.2	9.0	8.8	8.5	8.1	7.6	7.2	6.7	6.2	5.8	4	2			
VXm 10/50-I	0.75	1	6	5.9	5.7	5.5	5.4	5.3	5.2	5	4.8	4.6	4.4	4.1	3.8	3.6	2.8	2	1		
			7.5	7.4	7.2	7	6.9	6.8	6.7	6.5	6.2	5.9	5.8	5.5	5.2	5	4	3.2	2.4	1.5	

TIPO Monofase	POTENZA		Q m³/h l/min	H (metri)																BOCCA DN	
	kW	HP		0	3.0	6.0	9.0	12	15	18	21	24.0	27	30	36	42	48				
MCm 10/50	0.75	1	0	3.0	6.0	9.0	12	15	18	21	24.0	27	30	36	42	48	BOCCA DN				
MCm 12/50	1.1	1.5	12	10.7	9.7	8.7	7.8	6.8	5.9	5	4	3	2								2"
MCm 10/50-I	0.75	1	15	14	13	12.3	11.5	10.5	9.7	8.8	8	7	6.2	4.5	2.7	1					
VXm 8/35	0.60	0.85	12	10.7	9.7	8.7	7.8	6.8	5.9	5	4	3	2								1 1/2"
VXm 10/35	0.75	1	8.4	7.5	6.5	5.2	3.7	2													
VXm 15/35	1.1	1.5	10	9.5	8.5	7.2	5.8	4	2												2"
VXm 8/50	0.60	0.85	15	14	13	11.8	10.5	9	7.5	6	4	2									
VXm 10/50	0.75	1	6	5.5	5	4.4	3.6	2.8	2	1											2"
VXm 15/50	1.1	1.5	7.5	7	6.5	5.8	5	4	3.2	2.4	1.5										
			11	10.5	10	9.5	9	8.3	7.5	6.8	6	5	4								

SAR 550

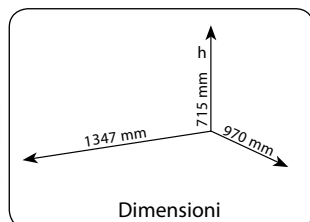

COMPONENTI

- Serbatoio in polietilene da 550 litri con coperchio
- Due elettropompe monofase
- Quadro elettrico
- Tre galleggianti con funzioni di minimo livello, massimo livello e alternanza pompe
- Collegamenti per tubazioni di ingresso Ø 110 mm, di uscita (vedi tabella) e di sfogo gas Ø 50 mm
- Tubi di guida per la discesa delle pompe (solo per VX-I)

A RICHIESTA

- **Kit di allarme** composto da un galleggiante, una sirena autoalimentata e un quadro elettrico
- **Prolunga da 300 mm** per l'apertura del serbatoio

TIPO Monofase	POTENZA		Q m³/h l/min	H (metri)											BOCCA DN						
	kW	HP		0	3.0	4.5	6.0	9.0	12	15	18	21	24.0								
ZXm 1B/40	0.50	0.70	0	3.0	4.5	6.0	9.0	12	15	18	21	24.0	BOCCA DN								
ZXm 1A/40	0.60	0.85	9	8.3	8	7.5	6.5	5.2	4	2.5	1										2"
VXm 8/35-I	0.60	0.85	11	10	9.5	9.2	8.2	7	5.7	4.3	2.8	1.5									
VXm 10/35-I	0.75	1	8.4	7.5	7	6.5	5.2	3.7	2												2"
VXm 8/50-I	0.60	0.85	10	9.5	9.0	8.5	7.2	5.8	4	2											
VXm 10/50-I	0.75	1	6	5.5	5.3	5	4.4	3.6	2.8	2	1										2"
			7.5	7	6.8	6.5	5.8	5	4.4	3.2	2.4	1.5									

TIPO Monofase	POTENZA		Q m³/h l/min	H (metri)																BOCCA DN	
	kW	HP		0	3.0	6.0	9.0	12	15	18	21	24.0	27	30	36	42	48				
MCm 10/50	0.75	1	0	3.0	6.0	9.0	12	15	18	21	24.0	27	30	36	42	48	BOCCA DN				
MCm 12/50	1.1	1.5	12	10.7	9.7	8.7	7.8	6.8	5.9	5	4	3	2								2"
VXm 8/35	0.60	0.85	15	14	13	12.3	11.5	10.5	9.7	8.8	8	7	6.2	4.5	2.7	1					
VXm 10/35	0.75	1	8.4	7.5	6.5	5.2	3.7	2													1 1/2"
VXm 15/35	1.1	1.5	10	9.5	8.5	7.2	5.8	4	2												
VXm 8/50	0.60	0.85	15	14	13	11.8	10.5	9	7.5	6	4	2									2"
VXm 10/50	0.75	1	6	5.5	5	4.4	3.6	2.8	2	1											
VXm 15/50	1.1	1.5	7.5	7	6.5	5.8	5	4	3.2	2.4	1.5										
			11	10.5	10	9.5	9	8.3	7.5	6.8	6	5	4								

SAR lifting stations for waste water collecting

The stations are ideal for lifting waste water in installations at a level below the sewage system. The available tank capacities are 40, 100, 250 and 550 litres, all equipped with a sealed cover to avoid any leaks of liquid or gas. The liquid temperature may reach +40°C, the limit value required by submersible pumps housed in tanks. The stations cannot be used in environments where there is a risk of explosion or for pumping inflammable liquids.

SAR 40

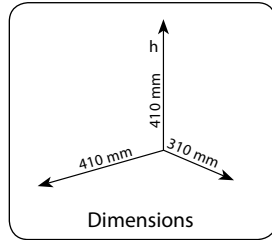

COMPONENTS

- 40-litres polyethylene tank with cover plate
- Single-phase pump with float switch and 5 metres supply cable with fitted Schuko plug
- Non-return valve
- Parts for connection of inlet pipe 1½" G, discharge pipe and vent pipe ½"G

TYPE Single phase	POWER		Q m³/h l/min	H (m)													PORT DN
	kW	HP		0	1.2	2.4	3.6	4.8	6.0	7.2	8.4	9.6	10.8	12	13.2		
SAR 40 - TOP1	0.25	0.33	0	0	20	40	60	80	100	120	140	160	180	200	220	1¼"	1"
SAR 40 - TOP 2	0.37	0.50	7	6	5.5	4.5	4	3	2.5	1.5	1						
SAR 40 - RXm 1	0.25	0.33	9	8	7.5	6.5	6	5.5	4.5	4	3	2.5	1.8	1			
SAR 40 - RXm 2	0.37	0.50	7.5	6.5	5.8	5	4.3	3.5	2.8	2	1						
SAR 40 - TOP-VORTEX	0.37	0.50	10	9.5	8.8	8	7.3	6.5	5.8	5	4.3	3.5	2.8	2			
			7	6.5	6	5.4	4.8	4.2	3.5	3	2.5	1.5					

SAR 100

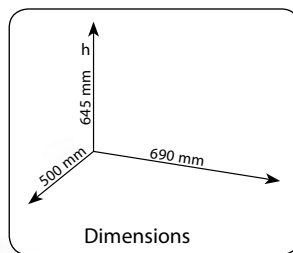

COMPONENTS

- 100-litres polyethylene tank with cover plate
- Single-phase pump with float switch and 5 metres supply cable with fitted Schuko plug
- Parts for connection of inlet pipe Ø 110 mm, discharge pipe and vent pipe Ø 50 mm

ON REQUEST

- Alarm kit composed of a float switch, a self-fed siren and a control box

TYPE Single phase	POWER		Q m³/h l/min	H (m)																				PORT DN				
	kW	HP		0	0.6	1.2	1.8	2.4	3.0	3.6	4.2	4.5	4.8	5.4	6.0	7.2	8.4	9.0	9.6	10.8	12.0	13.2	15.0		18.0	21.0	24.0	
SAR 100 - TOP 2	0.37	0.50	0	0	10	20	30	40	50	60	70	75	80	90	100	120	140	150	160	180	200	220	250	300	350	400	1¼"	1½"
SAR 100 - TOP - VORTEX	0.37	0.50	9	8.5	8	7.7	7.5	7	6.5	6.3	6.1	6	5.7	5.5	4.5	4	3.5	3	2.5	1.8	1							
SAR 100 - TOP - MULTI 2	0.55	0.75	7	6.7	6.5	6.2	6	5.7	5.4	5.2	5	4.8	4.5	4.2	3.5	3	2.6	2.5	1.5									
SAR 100 - RXm 2/20	0.37	0.50	30	29	28	27	26	24	22	19	17	15	10.5	5														
SAR 100 - ZXm 1B/40	0.50	0.70	7	6.7	6.5	6.2	6	5.7	5.4	5.2	5	4.8	4.5	4.3	3.7	3.1	2.8	2.5	2									
SAR 100 - ZXm 1A/40	0.60	0.85	9	8.7	8.6	8.5	8.4	8.3	8.1	8	7.9	7.8	7.6	7.5	7.1	6.6	6.5	6.1	5.7	5.2	4.7	4	2.5	1				
			11	10.7	10.5	10.4	10.3	10	9.7	9.6	9.5	9.3	9.2	9.1	8.8	8.6	8.2	7.8	7.4	7	6.5	5.7	4.3	2.8	1.5			

SAR 250

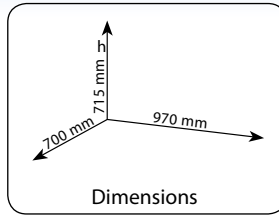

COMPONENTS

- 250-litres polyethylene tank with cover plate
- Single-phase pump with float switch and 5 metres supply cable with fitted Schuko plug
- Parts for connection of inlet pipe Ø 110 mm, discharge pipe and vent pipe Ø 50 mm
- Lowering device (only for VX-I)

ON REQUEST

- **Alarm kit** composed of a float switch, a self-fed siren and a control box
- **300 mm** step for opening the tank

TYPE Single phase	POWER		Q m ³ /h l/min	Flow rate (l/min)																PORT DN			
	kW	HP		0	1.2	2.4	3.0	3.6	4.5	4.8	6.0	7.2	8.4	9.0	9.6	10.8	12	15	18		21	24.0	
SAR 250 - TOP - VORTEX	0.37	0.50	H (m)	7	6.5	6	5.7	5.4	5	4.8	4.2	3.5	3	2.6	2.5	1.5							1 1/4"
SAR 250 - ZXm 1B/40	0.50	0.70		9	8.5	8.4	8.3	8.1	8	7.8	7.5	7.1	6.6	6.5	6.1	5.7	5.2	4	2.5	1			1 1/2"
SAR 250 - ZXm 1A/40	0.60	0.85		11	10.5	10.3	10	9.9	9.5	7.8	9.2	8.8	8.4	8.2	7.9	7.4	7	5.7	4.3	2.8	1.5		
SAR 250 - VXm 8/35-I	0.60	0.85		8.4	8.2	7.8	7.5	7.2	7	6.7	6.5	6.1	5.7	5.2	4.7	4.2	3.7	2					2"
SAR 250 - VXm 10/35-I	0.75	1		10	9.9	9.7	9.5	9.2	9.0	8.8	8.5	8.1	7.6	7.2	6.7	6.2	5.8	4	2				
SAR 250 - VXm 8/50-I	0.60	0.85		6	5.9	5.7	5.5	5.4	5.3	5.2	5	4.8	4.6	4.4	4.1	3.8	3.6	2.8	2	1			2"
SAR 250 - VXm 10/50-I	0.75	1		7.5	7.4	7.2	7	6.9	6.8	6.7	6.5	6.2	5.9	5.8	5.5	5.2	5	4	3.2	2.4	1.5		

TYPE Single phase	POWER		Q m ³ /h l/min	Flow rate (l/min)																PORT DN			
	kW	HP		0	3.0	6.0	9.0	12	15	18	21	24.0	27	30	36	42	48						
SAR 250 - MCm 10/50	0.75	1	H (m)	12	10.7	9.7	8.7	7.8	6.8	5.9	5	4	3	2									2"
SAR 250 - MCm 12/50	1.1	1.5		15	14	13	12.3	11.5	10.5	9.7	8.8	8	7	6.2	4.5	2.7	1						
SAR 250 - MCm 10/50-I	0.75	1		12	10.7	9.7	8.7	7.8	6.8	5.9	5	4	3	2									1 1/2"
SAR 250 - VXm 8/35	0.60	0.85		8.4	7.5	6.5	5.2	3.7	2														
SAR 250 - VXm 10/35	0.75	1		10	9.5	8.5	7.2	5.8	4	2													2"
SAR 250 - VXm 15/35	1.1	1.5		15	14	13	11.8	10.5	9	7.5	6	4	2										
SAR 250 - VXm 8/50	0.60	0.85		6	5.5	5	4.4	3.6	2.8	2	1												2"
SAR 250 - VXm 10/50	0.75	1		7.5	7	6.5	5.8	5	4	3.2	2.4	1.5											
SAR 250 - VXm 15/50	1.1	1.5		11	10.5	10	9.5	9	8.3	7.5	6.8	6	5	4									

SAR 550

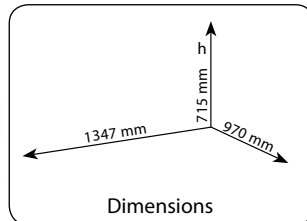

COMPONENTS

- 550-litres polyethylene tank with cover plate
- Two single-phase pumps
- Control panel
- Three float switches with functions of:
 - 1) alternate switching of one of the two pumps
 - 2) maximum level with switching of the second pump
 - 3) minimum level for switching off the pumps
- Connection for tubes for two inlets Ø 110 mm, for two outlets and for two air release Ø 50 mm
- Lowering device (only for VX-I)

ON REQUEST

- **Alarm kit** composed of a float switch, a self-fed siren and a control box
- **300 mm** step for opening the tank

TYPE Single phase	POWER		Q m ³ /h l/min	Flow rate (l/min)											PORT DN								
	kW	HP		0	3.0	4.5	6.0	9.0	12	15	18	21	24.0										
SAR 550 - ZXm 1B/40	0.50	0.70	H (m)	9	8.3	8	7.5	6.5	5.2	4	2.5	1										2"	
SAR 550 - ZXm 1A/40	0.60	0.85		11	10	9.5	9.2	8.2	7	5.7	4.3	2.8	1.5										
SAR 550 - VXm 8/35-I	0.60	0.85		8.4	7.5	7	6.5	5.2	3.7	2													
SAR 550 - VXm 10/35-I	0.75	1		10	9.5	9.0	8.5	7.2	5.8	4	2												
SAR 550 - VXm 8/50-I	0.60	0.85		6	5.5	5.3	5	4.4	3.6	2.8	2	1											
SAR 550 - VXm 10/50-I	0.75	1		7.5	7	6.8	6.5	5.8	5	4.4	3.6	2.8	2	1									

TYPE Single phase	POWER		Q m ³ /h l/min	Flow rate (l/min)																PORT DN			
	kW	HP		0	3.0	6.0	9.0	12	15	18	21	24.0	27	30	36	42	48						
SAR 550 - MCm 10/50	0.75	1	H (m)	12	10.7	9.7	8.7	7.8	6.8	5.9	5	4	3	2									2"
SAR 550 - MCm 12/50	1.1	1.5		15	14	13	12.3	11.5	10.5	9.7	8.8	8	7	6.2	4.5	2.7	1						
SAR 550 - VXm 8/35	0.60	0.85		8.4	7.5	6.5	5.2	3.7	2													1 1/2"	
SAR 550 - VXm 10/35	0.75	1		10	9.5	8.5	7.2	5.8	4	2													
SAR 550 - VXm 15/35	1.1	1.5		15	14	13	11.8	10.5	9	7.5	6	4	2										
SAR 550 - VXm 8/50	0.60	0.85		6	5.5	5	4.4	3.6	2.8	2	1												2"
SAR 550 - VXm 10/50	0.75	1		7.5	7	6.5	5.8	5	4	3.2	2.4	1.5											
SAR 550 - VXm 15/50	1.1	1.5		11	10.5	10	9.5	9	8.3	7.5	6.8	6	5	4									